

SAMSUNG

WIRELESS CHARGER STAND

USER MANUAL

EP-N5200

09/2019. Rev.1.1

www.samsung.com

Read me first

Please read this manual before using the device to ensure safe and proper use.

- Images may differ in appearance from the actual product. Content is subject to change without prior notice.
- Before using the wireless charger, make sure it is compatible with your device.

Instructional icons



Warning: situations that could cause injury to yourself or others



Caution: situations that could cause damage to your device or other equipment



Notice: notes, usage tips, or additional information

Getting started

Package contents

Check the product box for the following items:

- Wireless charger
- USB power adaptor
- USB cable
- Quick start guide



- Wireless charging covers are sold separately.
- The items supplied with the device and any available accessories may vary depending on the region or service provider.
- The supplied items are designed only for this device and may not be compatible with other devices.
- Appearances and specifications are subject to change without prior notice.
- You can purchase additional accessories from your local Samsung retailer. Make sure they are compatible with the device before purchase.
- Use only Samsung-approved accessories. Using unapproved accessories may cause the performance problems and malfunctions that are not covered by the warranty.
- Availability of all accessories is subject to change depending entirely on manufacturing companies. For more information about available accessories, refer to the Samsung website.

Device layout

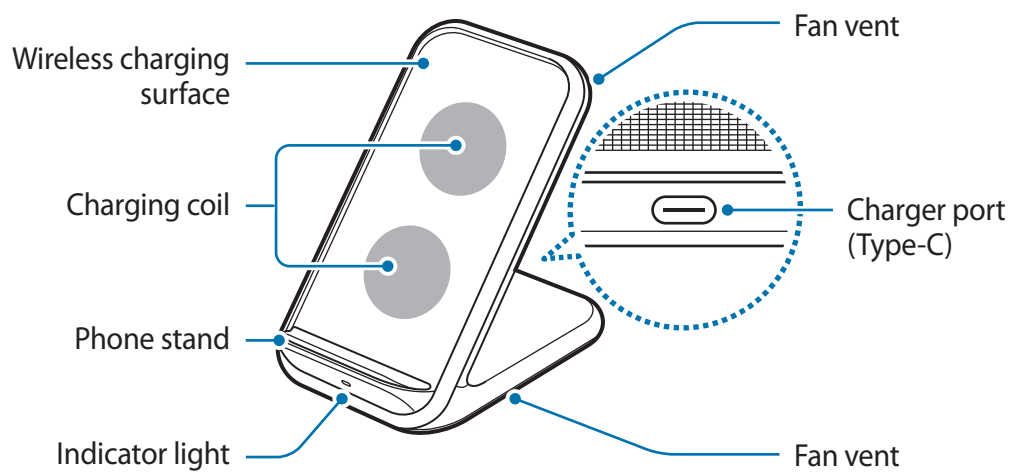

Using the wireless charger

Charging your mobile device

- 1 Connect the charger to the wireless charger.

When the charger is correctly connected to the wireless charger, the indicator light flashes red, green, and orange, and then turns off.



Use only Samsung-approved chargers (9.0 V/2.77 A) provided with the wireless charger.

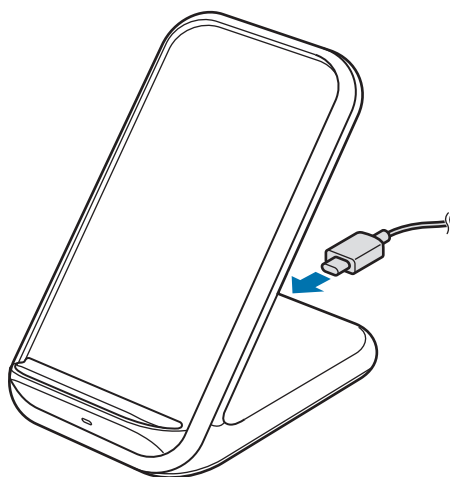

2 Place a supported mobile device on the phone stand.

- Charging will begin when the wireless charging surface comes into contact with the mobile device's wireless charging coil.
- Check the charging icon displayed on the mobile device's screen for the charging status.
- To begin fast wireless charging, place a mobile device that supports fast wireless charging on the wireless charger. For more information, refer to the mobile device's user manual.

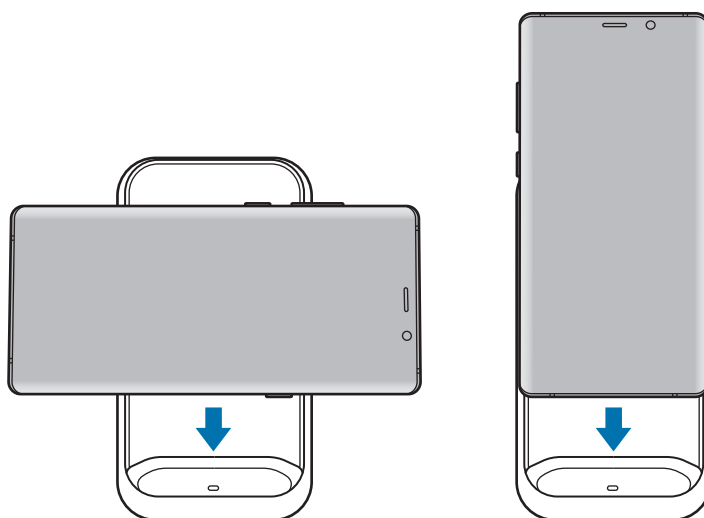

3 When the mobile device is fully charged, remove the mobile device from the wireless charger.



Precautions for mobile device charging

- Do not place the mobile device on the wireless charger with a credit card or radio-frequency identification (RFID) card (such as a transportation card or a key card) placed between the back of the mobile device and the mobile device cover.
- Do not place the mobile device on the wireless charger when conductive materials, such as metal objects and magnets, are placed between the mobile device and the wireless charger.

The mobile device may not charge properly or may overheat, or the mobile device and the cards may be damaged.



- You may need to purchase a charger separately depending on the wireless charger you bought.
- Depending on the location of the mobile device's wireless charging coil, your mobile device may not charge properly.
- Wireless charging may not work properly if you have attached a thick case to your mobile device. If your case is thick, remove it before placing your mobile device on the wireless charger.
- If you connect a charger to the mobile device during wireless charging, the wireless charging feature will be unavailable.
- If you use the wireless charger in areas with weak network signals, you may lose network reception.
- The fan inside the wireless charger may produce noise during fast wireless charging. When you deactivate the fast wireless charging feature, the fan noise will be reduced. To see how to deactivate the fast wireless charging feature, refer to the mobile device's user manual.
- To save energy, unplug the charger when not in use. The charger does not have a power switch, so you must unplug the charger from the electric socket when not in use to avoid wasting power. The charger should remain close to the electric socket and easily accessible while charging.

Indicator light identification

The indicator light alerts you to the wireless charger's status.

Colour	Status
Red → Green → Orange	<ul style="list-style-type: none">• When connected to a power outlet
Red	<ul style="list-style-type: none">• When charging
Green	<ul style="list-style-type: none">• When fully charged
Flashing red	<ul style="list-style-type: none">• When not charging properly due to a general error
Off	<ul style="list-style-type: none">• When the mobile device is removed from the wireless charger or when the wireless charger is not connected to a power outlet



- If the indicator light does not work as described, disconnect the charger from the wireless charger and reconnect it.
- The indicator light may work differently depending on the mobile device or the wireless charging cover.

Copyright

Copyright © 2019 Samsung Electronics

This manual is protected under international copyright laws.

No part of this manual may be reproduced, distributed, translated, or transmitted in any form or by any means, electronic or mechanical, including photocopying, recording, or storing in any information storage and retrieval system.

Trademarks

- SAMSUNG and the SAMSUNG logo are registered trademarks of Samsung Electronics.
- All other trademarks and copyrights are the property of their respective owners.